

Triton Cloud Sound Shapes™

Shaped Acoustic Panels. NRC 1.00

Technical Data sheet



SONO

Description.

The Sound Shapes™ range was developed as a response in the market for more free-form suspended and direct fixed acoustic panels that could work in unconventional spaces. Sound Shapes™ are high sound absorbing glass fibre ceiling clouds designed to work together in formations and clusters to control unwanted noise & reverberation. The panels can be direct fixed to the lining or suspended individually or in clusters on a frame.

Application.

The Sound Shapes™ panels are ideal for receptions, meeting rooms, quiet rooms, showrooms, galleries, retail spaces, offices and hospitality.

Composition.

Made in NZ from 80% recycled bio-soluble glass fibre core, laminated with Sonatex™ composite or white woven glass fabric or other fabric wrapped finishes.

Benefits.

- Adds drama and ceiling focal point to interiors.
- High NRC sound absorption rating for control of reverberation.
- Light weight, non combustible and dimensionally stable.
- Available in a wide range of colours, wood-grain print and fabric finishes.
- The Sound Shape range can be clustered and mixed & matched together to form exciting organic formations.
- Highly decorative and versatile to accommodate technically challenging spaces.
- 80% recycled glass core, low in FOC and Group 1S fire rating (Fabric wrapped panels will be Group 2 dependant upon fabric used)
- Direct fixed to linings, suspended individually or set on a frame.
- GreenTag Certified / Level A



Shape	Large Size	Standard Size
Triangle	40x1100x715mm max	40x815x530mm
Pentagon	40x1100x1050mm max	40x510x480mm
Octagon	40x1080x1000mm max	40x570x530mm
Hexagon	40x1120x970mm max	40x620x530mm
Rhomboid	40x1180x900mm max	40x620x530mm
Diamond	40x1180x1000mm max	40x620x530mm
Circle	40x1170mm dia. max	40x600mm dia.

NB: Cloud shape must not exceed maximum sizes indicated.



Technical Specifications

Finishes:

Sonatex: (White AS180) (Mid Grey RAL7040) (Light Grey RAL7030) (Grey White RAL9002) (Wood Wool Print) (Plaster Print) (Wood Print over RAL1014 Oak) (Wood Print over RAL1013 Blond) (Wood Print over RAL8019 Walnut) (Zinc Yellow RAL1018) (Ivory RAL1014) (Graphite Black RAL9011) (Traffic Red RAL3020) (Orient Red RAL3031) (Traffic Orange RAL2009) (Traffic Green RAL6032) (Aqua RAL6027) or (1963 White Glass Woven Fibre Fabric), other finishes to order.

Environmental impact:

Core from 80% recycled local waste glass, product and packaging can be reused/recycled in NZ.
Low VOC <0.002 Mg/M²/hr per ASTM D5116

Fire Reaction:

Sonatex & Glass Woven Fabric Group 1S. C/VM2 / ISO 5660.1. NB: Polyester, wool fabric wrapped panels will be Group 2 dependant upon fabric used.

Humidity:

Max 90% R/H at 45°C.

Light reflectance:

ASTM C1477 LR-1, >75% White

Maintenance:

Clean with vacuum, soft brush or damp cloth. Re-surfacing of soiled panels available, consult Asona.

NZ/AU Building Code:

Clause B2—durability, 5 years

Weight:

3.75 kg/m²

Tolerances:

Less than -3mm per panel

Installation:

Triton Cloud Sound Shapes™ range is a finishing trade, installation shall not commence until the building is water tight, dry and free of dust and debris. Direct fix or suspend using cloud suspension kits.

Specification:

Acoustic panels shall be Asona Triton Cloud Sound Shapes™ panels as manufactured and supplied by Asona Ltd Tel: 09 525 6575 Fax: 09 525 6579, item # (), size shall be () x ()mm, thickness shall be 40 x () x ()mm, finish shall be Sonatex: (White AS180) (Mid Grey RAL7040) (Light Grey RAL7030) (Grey White RAL9002) (Wood Wool Print) (Plaster Print) (Wood Print over RAL1014 Oak) (Wood Print over RAL1013 Blond) (Wood Print over RAL8019 Walnut) (Zinc Yellow RAL1018) (Ivory RAL1014) (Graphite Black RAL9011) (Traffic Red RAL3020) (Orient Red RAL3031) (Traffic Orange RAL2009) (Traffic Green RAL6032) (Aqua RAL6027) or (1963 White Glass Woven Fibre Fabric). Sonatex Cloud panels shall be delivered to site with protective plastic film coating that is to be removed on installation.

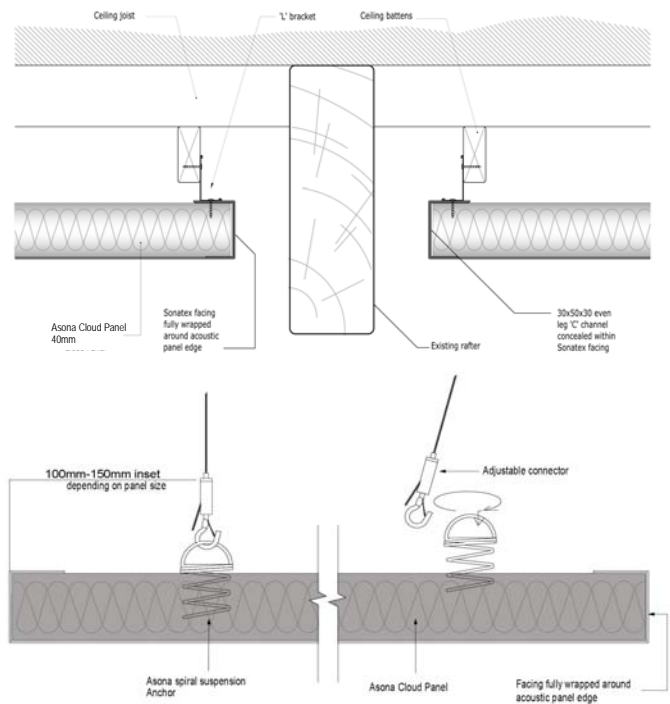
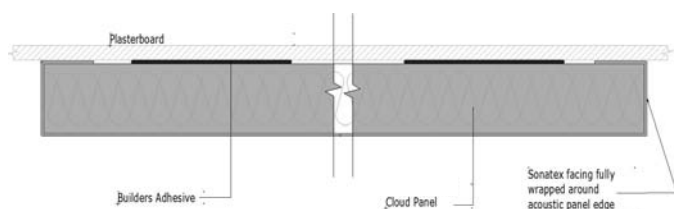

Supplied by:

Asona

Tel: 1800 240 361
info@asona.com.au
www.asona.com.au

Factory:
Building 14, 7 Cain Road
Penrose, Auckland, New Zealand
Tel: +64(9) 525 6575

© Copyright ASONA 2017
Triton is a trade mark of Asona All dimensions are nominal. We reserve the right to change specifications.
Ref. Sound Shapes-1706