

Triton Cloud Panel™ - NRC 1.00

Edge Wrapped Floating Acoustic Panel

Technical Data sheet



SONO

Description.

Triton Cloud Panel™ is a proprietary edge wrapped glass fibre, high sound absorbing acoustic panel faced with either Sonatex™ glass mat acoustic facing, 1963 woven glass fabric or wrapped in fabric.

Application.

Triton Cloud Panel™ is designed as a free floating acoustic ceiling panel or direct fixed ceiling & wall panel. Ideal for call centres, offices, corridors, schools, halls and gymnasiums.

Composition.

Manufactured in NZ, from bio-soluble glass fibre core, metal reinforced edges or frameless, wrapped in either 2 ply Sonatex™ glass mat composite finish, white 1963 woven glass fabric or fabric wrapped for a clean frameless look.

Benefits.

- Glass fibre core provides very high sound absorption, NRC 1.00, ISO 11654 class A, α_W 1.0
- Clean frameless look with wrapped edges.
- High light reflectance in standard white, colours available
- Available in standard or custom sizes
- Can have reinforced aluminium edges or frameless
- Dimensionally stable in high humidity, special version available for use in swimming pool applications
- Made in NZ, low embodied energy, 80% recycled content
- Available in 40,50,75,100mm thicknesses
- Large selection of fabrics available
- Width 1200mm max, length to 3000mm subject to type.
- Reinforced edges or frameless options
- *GreenTag certified / Level A (Sonatex, Frameless, Aluminium Edge), Level B (Sonatex, Frameless, Steel Edge), Level C (Beehive & Woven Image fabric ranges only).

Technical Specifications

Sound Absorption Rating:						
ISO 354 E-200 α_W 1.0; NRC 1.05 per ASTM C423						
Test reports T0601-2, T0601-5						
Hz	125	250	500	1000	2000	4000
α_p E200	0.70	1.00	1.00	1.00	1.00	0.95
α_p A50	0.25	0.85	1.00	1.00	0.95	0.90

Fabric wrapped



Sonatex White



Woven Glass Fabric

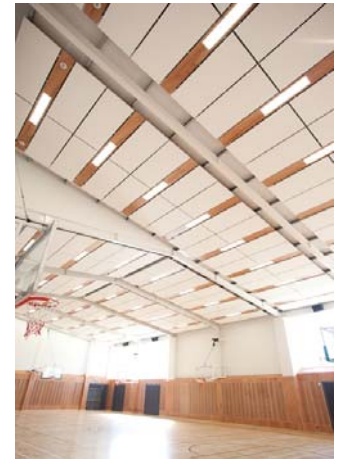

* see restrictions above

Technical Specifications

Sizes:

Thickness: 40,50,75,100mm
 Width: 600, 900, 1000 ,(1200mm) subject to Cloud Panel facing.
 Length: 600, 900, 1000, 1200, 2000, 2400, 2700, 3000 mm
 Other sizes to order, please consult Asona Ltd.

Back loading:

Max. 1.5 kg/m², point loads shall be independently supported.

Weight:

1.9 kg/m²

Colour:

Sonatex:(White AS180) (Mid Grey RAL7040) (Light Grey RAL7030) (Grey White RAL9002) (Wood Wool Print) (Plaster Print) (Wood Print over RAL1014 Oak) (Wood Print over RAL1013 Blond) (Wood Print over RAL8019 Walnut) (Zinc Yellow RAL1018) (Ivory RAL1014) (Graphite Black RAL9011)(Traffic Red RAL3020) (Orient Red RAL3031) (Traffic Orange RAL2009) (Traffic Green RAL6032) (Aqua RAL6027) or (1963 White Glass Woven Fibre Fabric) or standard fabric ranges. Other colours and fabrics to order.

Environmental impact:

From 80% recycled local content, low embodied energy, damaged or soiled panels can be reused/ resurfaced with new acoustic facing to reduce construction waste and costs. Low VOC.

Fire Reaction:

Material group number: 1S (highest rating) C/VM2 / ISO 5660.1. Suitable for fire exit way and all other sprinklered & non sprinklered buildings. NB: Use of certain fabrics may effect the fire rating, please consult Asona.

Humidity:

Non hydroscopic, dimensionally stable, resists fungi and stains. Max 99% R/H at 45°C.

Light reflectance:

ASTM C1477 LR-1, >82% White

NZ Building Code:

Clause B2—durability, 5 years

Maintenance:

Clean with vacuum, soft brush or damp cloth. Re-surfacing of soiled panels available, consult Asona.

Service Panels:

Available with protective plastic film covering which will help keep panels cleaning during installation of M/E services.

Thermal Resistance:

R 1.47 m²°C/W

Tolerance:

Less than -3 mm

Installation:

Shall not commence until the building is water tight and dry. Light/mechanical fittings shall be independently supported, place mounting board at rear of panel to support fixtures. Mount panels on hanger wire or direct fix brackets @ 1200 centres. Sub-trades not to use panels for support.

Specification:

Acoustical treatment shall be Triton Cloud Panel, from glass fibre core, (reinforced edges) or (frameless) wrapped in (2 ply Sonatex glass mat composite)(1963 White woven glass fabric)(Fabric) finish to face and edges as manufactured by Asona Ltd tel: 09 525 6575, item # () , module () x ()mm

Fixing Options

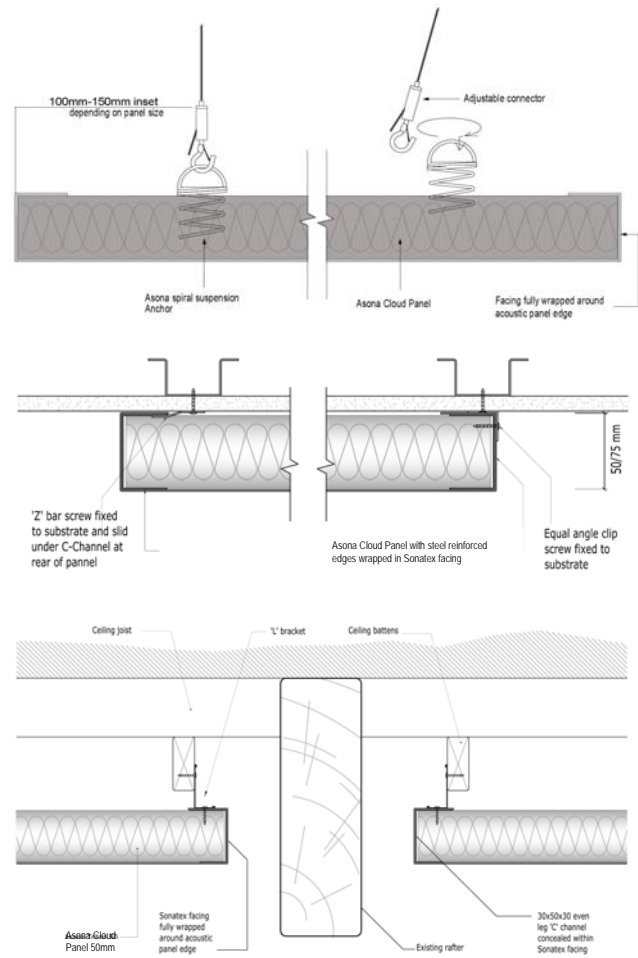

(40)(50)(75)(100) mm thick, sound absorption Class A, α_W 1.0, NRC 1.00, thermal insulation R1.47, fire group: 1S, colour () or fabric(). Mount panels to structure via (suspension wire), (direct fix brackets) fixings @ 1200mm centres. Supply service panels with protective strippable plastic film facing.

Asona Ltd

P.O Box 96-241 Balmoral,
 Auckland, New Zealand
 Sales:
 Tel: 09 525 6575
 Email: info@asona.co.nz
 Web: www.asona.co.nz

Factory:
 Building 14, 7 Cain Road
 Penrose
 Auckland, New Zealand
 Tel: (09) 525 6575
 Fax: (09) 525 6579

Triton Cloud Sound Shapes™

Shaped Acoustic Panels. NRC 1.00

Technical Data sheet



SONO

Description.

The Sound Shapes™ range was developed as a response in the market for more free-form suspended and direct fixed acoustic panels that could work in unconventional spaces. Sound Shapes™ are high sound absorbing glass fibre ceiling clouds designed to work together in formations and clusters to control unwanted noise & reverberation. The panels can be direct fixed to the lining or suspended individually or in clusters on a frame.

Application.

The Sound Shapes™ panels are ideal for receptions, meeting rooms, quiet rooms, showrooms, galleries, retail spaces, offices and hospitality.

Composition.

Made in NZ from 80% recycled bio-soluble glass fibre core, laminated with Sonatex™ composite or white woven glass fabric or other fabric wrapped finishes.

Benefits.

- Adds drama and ceiling focal point to interiors.
- High NRC sound absorption rating for control of reverberation.
- Light weight, non combustible and dimensionally stable.
- Available in a wide range of colours, wood-grain print and fabric finishes.
- The Sound Shape range can be clustered and mixed & matched together to form exciting organic formations.
- Highly decorative and versatile to accommodate technically challenging spaces.
- 80% recycled glass core, low in FOC and Group 1S fire rating (Fabric wrapped panels will be Group 2 dependant upon fabric used)
- Direct fixed to linings, suspended individually or set on a frame.
- GreenTag Certified / Level A



Shape	Large Size	Standard Size
Triangle	40x1100x715mm max	40x815x530mm
Pentagon	40x1100x1050mm max	40x510x480mm
Octagon	40x1080x1000mm max	40x570x530mm
Hexagon	40x1170x1015mm max	40x670x580mm
Rhomboid	40x1180x900mm max	40x620x530mm
Diamond	40x1180x1000mm max	40x620x530mm
Circle	40x1170mm dia. max	40x600mm dia.

NB: Cloud shape must not exceed maximum sizes indicated.



Technical Specifications

Finishes:

Sonatex: (White AS180) (Mid Grey RAL7040) (Light Grey RAL7030) (Grey White RAL9002) (Wood Wool Print) (Plaster Print) (Wood Print over RAL1014 Oak) (Wood Print over RAL1013 Blond) (Wood Print over RAL8019 Walnut) (Zinc Yellow RAL1018) (Ivory RAL1014) (Graphite Black RAL9011) (Traffic Red RAL3020) (Orient Red RAL3031) (Traffic Orange RAL2009) (Traffic Green RAL6032) (Aqua RAL6027) or (1963 White Glass Woven Fibre Fabric), other finishes to order.

Environmental impact:

Core from 80% recycled local waste glass, product and packaging can be reused/recycled in NZ.
Low VOC <0.002 Mg/M²/hr per ASTM D5116

Fire Reaction:

Sonatex & Glass Woven Fabric Group 1S. C/VM2 / ISO 5660.1. NB: Polyester, wool fabric wrapped panels will be Group 2 dependant upon fabric used.

Humidity:

Max 90% R/H at 45°C.

Light reflectance:

ASTM C1477 LR-1, >75% White

Maintenance:

Clean with vacuum, soft brush or damp cloth. Re-surfacing of soiled panels available, consult Asona.

NZ Building Code:

Clause B2—durability, 5 years

Weight:

3.75 kg/m²

Tolerances:

Less than +/-3mm per panel

Installation:

Triton Cloud Sound Shapes™ range is a finishing trade, installation shall not commence until the building is water tight, dry and free of dust and debris. Direct fix or suspend using cloud suspension kits.

Specification:

Acoustic panels shall be Asona Triton Cloud Sound Shapes™ panels as manufactured and supplied by Asona Ltd Tel: 09 525 6575 Fax: 09 525 6579, item # (), size shall be () x ()mm, thickness shall be 40 x () x ()mm, finish shall be Sonatex:(White AS180) (Mid Grey RAL7040) (Light Grey RAL7030) (Grey White RAL9002) (Wood Wool Print) (Plaster Print) (Wood Print over RAL1014 Oak) (Wood Print over RAL1013 Blond) (Wood Print over RAL8019 Walnut) (Zinc Yellow RAL1018) (Ivory RAL1014) (Graphite Black RAL9011) (Traffic Red RAL3020) (Orient Red RAL3031) (Traffic Orange RAL2009) (Traffic Green RAL6032) (Aqua RAL6027) or (1963 White Glass Woven Fibre Fabric). Sonatex Cloud panels shall be delivered to site with protective plastic film coating that is to be removed on installation.

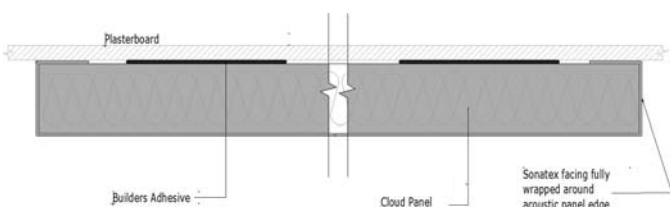
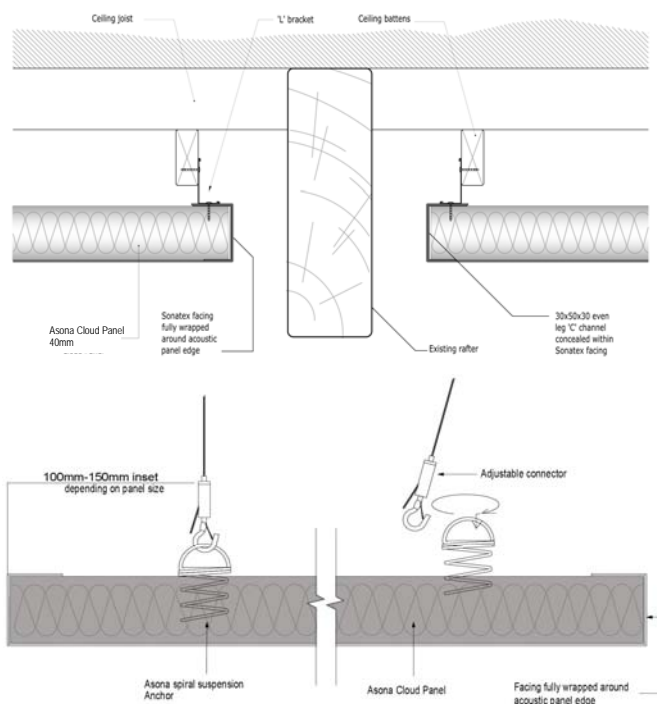

Asona Ltd

P.O Box 96-241 Balmoral,
Auckland, New Zealand
Sales: 09 525 6575
Email: info@asona.co.nz
Web: www.asona.co.nz

Factory:
Building 14, 7 Cain Road
Penrose
Auckland, New Zealand
Tel: (09) 525 6575
Fax: (09) 525 6579

ISO 9001:2008 Registered Firm No. NZ1014

© Copyright ASONA Ltd 2015
Asona, Cloud Sound Shapes, Sonatex are trade marks of Asona Ltd
All dimensions are nominal. We reserve the right to change specifications.
Ref. Cloud Sound Shapes-1504